



# OFFSET STEEL DRIVE CHAIN—MXS Class & MSS Class

## MOLINE OFFSET STEEL DRIVE CHAIN MATERIALS— MXS CLASS & MSS CLASS

MOLINE CHAIN NO.	ROLLERS	PINS	BUSHINGS	SIDEBARS
<b>MXS CLASS OFFSET DRIVE CHAIN—"Bushed Roller Type"</b>				
MXS 432	Carbon Steel Thru Hardened	Carbon Steel Case Hardened	Carbon Steel Case Hardened	Carbon Steel Heat Treated
MXS 88B	Alloy Steel Thru Hardened	Alloy Steel Induction Hardened	Alloy Steel Case Hardened	Alloy Steel Heat Treated
MXS 881	Carbon Steel Thru Hardened	Carbon Steel Case Hardened	Carbon Steel Case Hardened	Carbon Steel Heat Treated
MXS 882	Carbon Steel Thru Hardened	Carbon Steel Case Hardened	Carbon Steel Case Hardened	Carbon Steel Heat Treated
MXS 1031	Alloy Steel Thru Hardened	Alloy Steel Induction Hardened	Alloy Steel Case Hardened	Alloy Steel Heat Treated
MXS 1242	Alloy Steel Thru Hardened	Alloy Steel Induction Hardened	Alloy Steel Case Hardened	Alloy Steel Heat Treated
MXS 1245	Alloy Steel Thru Hardened	Alloy Steel Induction Hardened	Alloy Steel Case Hardened	Alloy Steel Heat Treated
MXS 2070	Alloy Steel Thru Hardened	Alloy Steel Thru Hardened	Alloy Steel Case Hardened	Alloy Steel Heat Treated
MXS 3011	Alloy Steel Thru Hardened	Alloy Steel Induction Hardened	Alloy Steel Case Hardened	Alloy Steel Heat Treated
MXS 3075	Alloy Steel Thru Hardened	Alloy Steel Induction Hardened	Alloy Steel Case Hardened	Alloy Steel Heat Treated
MXS 3514	Alloy Steel Thru Hardened	Alloy Steel Induction Hardened	Alloy Steel Case Hardened	Alloy Steel Heat Treated
MXS 4522	Alloy Steel Thru Hardened	Alloy Steel Induction Hardened	Alloy Steel Case Hardened	Alloy Steel Heat Treated
MXS 5031	Alloy Steel Thru Hardened	Alloy Steel Induction Hardened	Alloy Steel Case Hardened	Alloy Steel Heat Treated
MXS 5035	Alloy Steel Thru Hardened	Alloy Steel Induction Hardened	Alloy Steel Case Hardened	Alloy Steel Heat Treated
MXS 5542	Alloy Steel Thru Hardened	Alloy Steel Induction Hardened	Alloy Steel Case Hardened	Alloy Steel Heat Treated
MXS 6042	Alloy Steel Thru Hardened	Alloy Steel Induction Hardened	Alloy Steel Case Hardened	Alloy Steel Heat Treated
MXS 6565	Alloy Steel Thru Hardened	Alloy Steel Induction Hardened	Alloy Steel Case Hardened	Alloy Steel Heat Treated
<b>MXS CLASS OFFSET DRIVE CHAIN—"Steel Roller Type"</b>				
MSS 6065	—	Alloy Steel Induction Hardened	Alloy Steel Thru Hardened	Alloy Steel Heat Treated
<b>MSR CLASS STRAIGHT DRIVE CHAIN—"Bushed Roller Type"</b>				
MSR 6560	Alloy Steel Thru Hardened	Alloy Steel Induction Hardened	Alloy Steel Case Hardened	Alloy Steel Heat Treated

### ORDERING AND APPLICATION DATA

MOLINE CHAIN NO.	STYLE	PITCHES IN INCHES	STANDARD ANSI B29.10 NUMBER	LINKS PER 10 FEET	WEIGHT PER FOOT LBS.	AVERAGE ULTIMATE STRENGTH LBS.	RECOMMENDED MAXIMUM WORKING LOAD-LBS.
<b>MXS CLASS OFFSET DRIVE CHAIN—"Bushed Roller Type"</b>							
MXS 432	1	1.654	—	73	3.5	20,000	2,100
MXS 2070	2	2.000	—	60	7.6	70,000	3,890
MXS 881	1	2.609	—	46	3.0	20,000	2,300
MXS 882	1	2.609	—	46	3.6	26,000	2,500
MXS 3011	1	3.067	2,512	39	13.2	110,000	6,100
MXS 1031	1	3.075	—	39	7.3	48,000	4,650
MXS 3075	1	3.075	—	39	9.0	75,000	5,100
MXS 3514	1	3.500	2,814	34	16.0	140,000	7,650
MXS 1242	1	4.063	—	30	15.6	140,000	9,000
MXS 1245	1	4.073	3,315	30	18.6	170,000	10,050
MXS 4522	1	4.500	3,618	27	25.0	220,000	12,300
MXS 5031	1	5.000	4,020	24	36.0	310,000	17,500
MXS 5035	1	5.000	—	24	38.1	350,000	19,600
MXS 5542	1	5.500	—	22	49.1	420,000	23,700
MXS 88B	1	5.750	—	21	49.0	420,000	23,700
MXS 6042	1	6.000	4,824	20	46.5	420,000	23,700
MXS 6565	1	6.500	—	18.5	78.5	600,000	30,600
<b>MSS CLASS OFFSET DRIVE CHAIN—"Steel Bushed Type"</b>							
MSS 6065	3	6.000	—	20	51.7	600,000	27,600
<b>MSR CLASS STRAIGHT DRIVE CHAIN—"Bushed Roller Type"</b>							
MSR 6560	4	6.500	—	18.5	72.0	600,000	30,600

# OFFSET STEEL DRIVE CHAIN—MXS Class & MSS Class



AVAILABLE IN COTTERED  
CONSTRUCTION ONLY

## MXS Class Chain

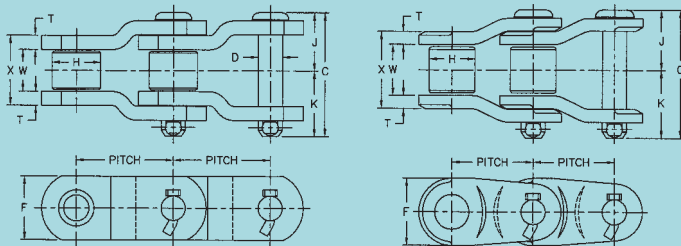

Style 1

Style 2

## MSS Class Chain

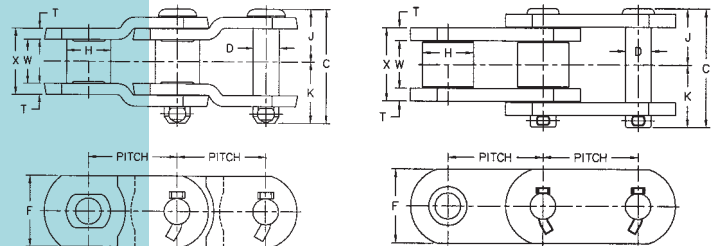

Style 3

Style 4

MOLINE CHAIN NO.	STYLE	PITCH IN INCHES	DIMENSIONS IN DECIMAL INCHES								
			OVER-ALL WIDTH- COTTERED C	DIAMETER OF PIN D	HEIGHT OF SIDEBAR F	DIAMETER OF ROLLER H	HEAD OF PIN TO CENTER LINE J	END OF PIN TO CENTER LINE K	THICKNESS OF SIDEBARS T	DISTANCE BETWEEN SIDEBARS W	LENGTH OF BUSHING X
<b>MXS CLASS OFFSET DRIVE CHAIN—"Bushed Roller Type"</b>											
MXS 432	1	1.654	2.28	0.438	1.12	0.88	1.02	1.26	0.19	1.00	1.38
MXS 2070	2	2.000	3.22	0.593	1.62	1.12	1.47	1.75	0.31	1.25	1.88
MXS 881	1	2.609	2.38	0.438	1.12	0.88	1.09	1.28	0.19	1.12	1.50
MXS 882	1	2.609	2.62	0.438	1.12	0.88	1.22	1.41	0.25	1.12	1.62
MXS 3011	1	3.067	3.94	0.750	2.25	1.62	1.81	2.12	0.38	1.56	2.31
MXS 1031	1	3.075	3.38	0.625	1.50	1.25	1.59	1.84	0.31	1.50	2.12
MXS 3075	1	3.075	3.69	0.648	1.75	1.25	1.72	1.97	0.38	1.50	2.25
MXS 3514	1	3.500	4.44	0.875	2.25	1.75	2.06	2.38	0.50	1.50	2.50
MXS 1242	1	4.063	4.88	0.875	2.25	1.75	2.25	2.62	0.50	1.94	2.94
MXS 1245	1	4.073	5.12	0.938	2.38	1.78	2.38	2.75	0.56	1.94	3.06
MXS 4522	1	4.500	5.25	1.100	3.00	2.25	2.44	2.81	0.56	2.06	3.19
MXS 5031	1	5.000	6.25	1.250	3.50	2.50	2.91	3.34	0.62	2.75	4.00
MXS 5035	1	5.000	6.62	1.375	3.50	2.50	3.12	3.50	0.75	2.56	4.06
MXS 5542	1	5.500	7.12	1.500	4.00	3.00	3.28	3.84	0.75	3.00	4.50
MXS 88B	1	5.750	7.12	1.500	4.00	3.00	3.28	3.84	0.75	3.00	4.50
MXS 6042	1	6.000	7.12	1.500	4.00	3.00	3.28	3.84	0.75	3.00	4.50
MXS 6565	1	6.500	8.06	1.750	5.00	3.50	3.81	4.25	0.88	3.25	5.00
<b>MSS CLASS OFFSET DRIVE CHAIN—"Steel Bushed Type"</b>											
MSS 6065	3	6.000	7.32	1.750	4.75	3.00	3.44	3.88	0.75	3.00	4.50
<b>MSR CLASS STRAIGHT DRIVE CHAIN—"Bushed Roller Type"</b>											
MSR 6560	4	6.500	8.06	1.750	5.00	3.50	3.81	4.25	0.88	3.25	5.00

Allied-Locke Industries Inc. . . . chain - sprockets - buckets [www.alliedlocke.com](http://www.alliedlocke.com)