



ALLIED-LOCKE INDUSTRIES INC.

STOCK FLEXIBLE COUPLINGS

BORED TO SIZE COUPLINGS WITH FINISHED BORE, KEYWAY, AND SET SCREW

No. of Teeth	Computer Number	Stock Finished Bores Include Standard Keyway and Setscrew	Hub Diameter	Length Thru Bore	Coupling O.D.	Weight Lbs.
12	4012HE	1/2 - 5/8 - 3/4	1 13/32	1 1/8	2 13/32	.4
16	4016HE	5/8 - 3/4 - 7/8 - 15/16 - 1 - 1 1/8 - 1 3/16 - 1 1/4	1 31/32	1 1/8	3 1/32	.8
16	5016HE	3/4 - 7/8 - 1 - 1 1/8 - 1 3/16 - 1 1/4 - 1 3/8 - 1 7/16 - 1 1/2 - 1 5/8	2 1/2	1 7/16	3 25/32	1.6
18	5018HE	3/4 - 7/8 - 1 - 1 1/8 - 1 3/16 - 1 1/4 - 1 3/8 - 1 7/16 - 1 1/2 - 1 5/8 - 1 3/4 - 1 7/8 - 1 15/16	2 31/32	1 11/16	4 3/16	2.4
18	6018HE	1 - 1 1/8 - 1 3/16 - 1 1/4 - 1 3/8 - 1 7/16 - 1 1/2 - 1 5/8 - 1 3/4 - 1 7/8 - 1 15/16 - 2 - 2 1/8 - 2 3/16 - 2 1/4 - 2 3/8 - 2 7/16	3 1/2	1 7/8	5	4.8
20	6020HE	1 1/8 - 1 1/4 - 1 1/2 - 1 3/4 - 1 15/16 - 2 1/8 - 2 3/8 - 2 7/16 - 2 5/8	3 7/8	2	5 1/2	5.2
22	6022HE	1 1/8 - 1 3/4 - 1 7/8 - 1 15/16 - 2 1/8 - 2 3/8 - 2 7/16 - 2 5/8 - 2 3/4 - 2 7/8	4 1/2	2 1/8	5 61/64	7.8
18	8018HE	1 1/8 - 1 3/4 - 1 15/16 - 2 - 2 1/8 - 2 3/8 - 2 7/16 - 2 5/8 - 2 7/8 - 2 15/16	4 3/16	2 3/8	6 21/32	9.5
20	8020HE	1 1/2 - 2 3/16 - 2 7/16 - 2 11/16 - 2 15/16 - 3 1/8 - 3 3/8 - 3 7/16	5 3/8	2 5/8	7 19/64	13.4
18	10018HE	1 1/2 - 2 7/16 - 2 7/8 - 2 15/16 - 3 7/16	5 11/16	2 3/4	8 21/64	18.2
20	10020HE	2 - 3 3/8 - 3 7/16 - 3 15/16	6 23/32	3 1/8	9 1/8	25.0
18	12018HE	3 7/16 - 3 15/16 - 4 7/16	6 3/4	3 1/2	10	28.0
22	12022HE	4 3/8 - 4 7/16 - 4 15/16	8 3/4	4	11 57/64	55.0

CAUTION: All rotating power transmission products are potentially dangerous and must be properly guarded for the speeds and applications for which they were intended.

COUPLING WITH PLAIN BORES FOR REBORING

Coupling Number	Maximum Bore Inches	Minimum Plain Bore Inches	Weight (Lbs.)	Hub (Inches)	
				Diameter	Length Thru
4012HE	7/8	7/16	.5	1 13/32	1 1/8
4016HE	1 5/16	5/8	1.0	1 31/32	1 1/8
5016HE	1 11/16	5/8	2.2	2 1/2	1 7/16
5018HE	2	3/4	3.5	2 31/32	1 11/16
6018HE	2 7/16	1	5.0	3 1/2	1 7/8
6020HE	2 3/4	1 1/8	6.5	3 7/8	2
6022HE	3	1 1/8	9.4	4 1/2	2 1/8
8018HE	3 1/8	1 1/8	11.0	4 3/16	2 3/8
8020HE	3 3/16	1 1/2	16.3	5 3/8	2 5/8
10018HE	3 7/8	1 1/2	20.3	5 11/16	2 3/4
10020HE	4 5/8	1 1/2	31.8	6 23/32	3 1/8
12018HE	4 11/16	2	36.8	6 3/4	3 1/2
12022HE	6 1/8	2	70.0	8 3/4	4

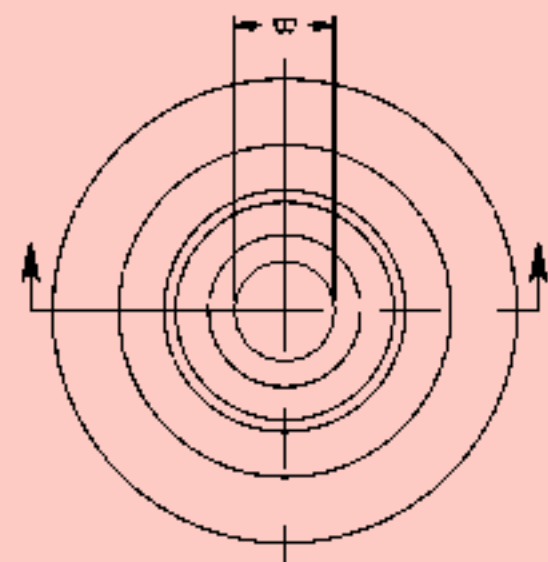
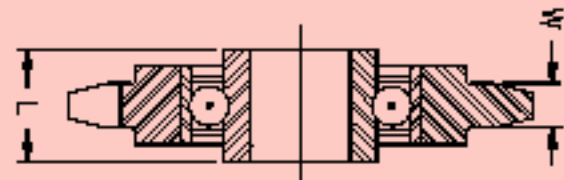

BALL BEARING IDLER SPROCKET HARDENED TEETH—HIGH SPEED

No. Teeth	Catalog Number	O.D.	B	L	W	Wt. Lbs.
20	35BB20HE	2.60	.038	.72	.168	.38
17	40BB17HE	2.97	.038	.72	.284	.52
18	40BB18HE	3.14	.038	.72	.284	.53
15	50BB15HE	3.32	.038	.72	.343	.75
17	50BB17HE	3.72	.038	.72	.343	.78
13	60BB13HE	3.51	.038	.72	.459	.76
15	60BB15HE	3.98	.038	.72	.459	1.06
12	80BB12HE	4.36	.750	.61	.575	1.50

NOTE: .038 Dia. is +.000, 750 is +.005—-.000

Allied-Locke Industries Inc.

... the company that delivers

www.alliedlocke.com