

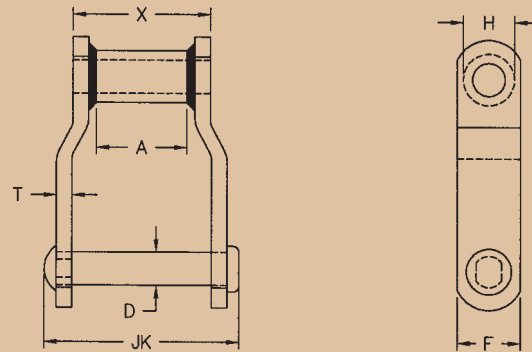

# WELDED MILL CHAIN

## OFFSET MILL TYPE CHAINS

Welded steel mill chains are recommended for most conveying, driving, and elevating applications where a high-strength steel rollerless chain is required. These chains will operate on the same sprockets as those of the replaceable cast chains. A complete line of attachments and optional heat treatment make them easily adaptable to a wide variety of applications.



CHAIN NO.	PITCH	AVERAGE ULTIMATE STRENGTH LBS.	RATED WORKING LOAD LBS.	APPROX. LINKS IN 10 FEET	AVERAGE WEIGHT PER FOOT	OVERALL WIDTH JK	LENGTH OF BEARING X	RIVET DIAMETER D	SIDE BAR THICKNESS T	SIDE BAR WIDTH F	BARREL DIAM. H	MAX. SPKT. FACE A
WH188	2.609	30,000	2,850	46	3.8	2.69	1.62	.50	.25	1.12	.88	.88
WH78	2.609	30,000	3,500	46	4.0	3.00	2.00	.50	.25	1.12	.88	1.12
WH78-4	4.000	30,000	3,500	30	4.0	3.00	2.00	.50	.25	1.12	.88	1.12
WH82	3.075	36,000	4,400	39	4.8	3.25	2.25	.56	.25	1.25	1.06	1.25
WH124	4.000	69,000	7,200	30	8.3	4.25	2.75	.75	.38	1.50	1.25	1.50
WH124HD	4.063	100,000	10,500	30	14.7	4.75	3.00	1.00	.50	2.00	1.62	1.62
WH111	4.760	91,000	8,850	26	9.5	4.88	3.38	.75	.38	1.75	1.25	2.00
WH106	6.000	69,000	7,200	20	7.0	4.25	2.75	.75	.38	1.50	1.25	1.62
WH106HD	6.000	92,500	7,875	20	9.0	4.75	3.00	.75	.50	1.50	1.25	1.62
WH106XHD	6.000	115,000	10,500	20	11.8	4.88	3.00	1.00	.50	2.00	1.62	1.62
WH110	6.000	69,000	7,875	20	7.2	4.62	3.00	.75	.38	1.50	1.25	1.88
WH132	6.050	115,000	15,300	20	14.2	6.25	4.38	1.00	.50	2.00	1.62	2.88
WH132HD	6.050	139,500	16,200	20	16.4	6.75	4.62	1.00	.62	2.00	1.62	2.88
WH150	6.050	116,000	15,300	20	16.8	6.25	4.38	1.00	.50	2.50	1.62	2.88
WH150HD	6.050	168,000	16,200	20	19.3	6.75	4.62	1.00	.62	2.50	1.62	2.88
WH150XHD	6.050	161,000	18,200	20	19.7	6.75	4.62	1.12	.62	2.50	1.62	2.88

- ★ Rivets are press fit to insure against pin rotation.
- ★ Automated welding is used to insure consistent welds and barrel location.
- ★ Pins, Barrels and sidebars are heat-treated as an Allied-Locke standard, to increase wear life of the chain. Chain with heat-treated rivets only are available upon request.